

模锻易拆链 Drop forged Rivetless chains

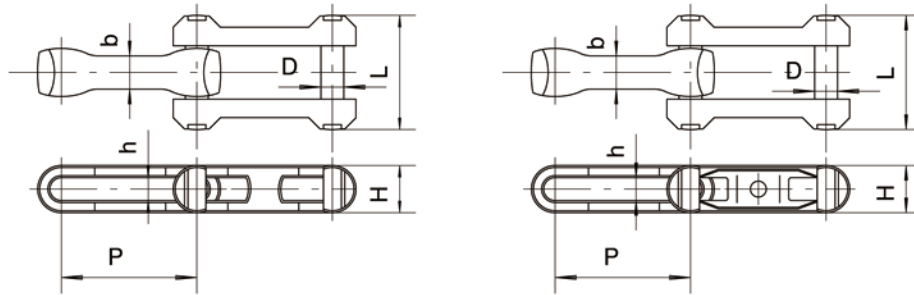

链号	节距	平均拉伸强度		销轴		链板			每米净重
Chain No.	Average pitch	Average ultimate strength		Pin		Sidebar			Average mass
		Not heat treated	Heat treated	Overall width	Pin dia.	Width of inner link	Height	Length of opening	kg/m
				L	D	b	H	h	
X458	102.4	/	21800	55.7	16	25.2	35.7	17.3	4.35
X678	153.2	/	38500	77	22	31.8	50.8	25.4	3.03
468	102.4	17200	31800	81	19.1	28.6	47.6	22.2	3.1
678	153.2	18100	32700	77	22	20.6	50.8	25.4	3
698	153.2	45400	59000	95.3	28.6	25.4	68.3	31.8	18.1

重载传动用弯板套筒链

Heavy-Duty Cranked-Sidebar Transmission Bush Chains

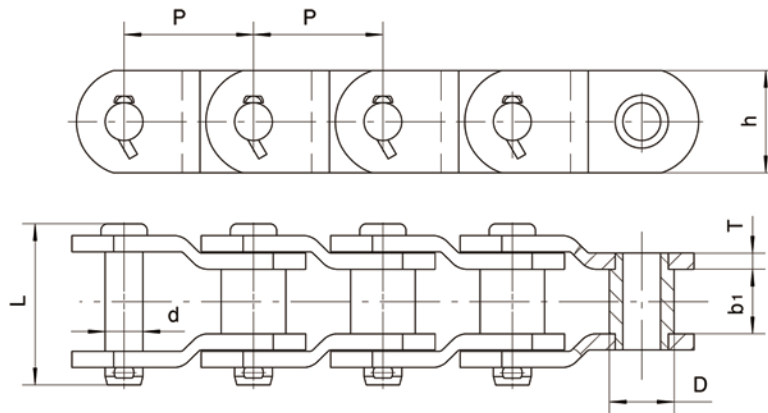

链号	节距	窄端内宽	套筒外径	链板		销轴		最小抗拉强度	许用工作载荷	每米净重
Chain No.	Pitch	Inside width at narrow end	Bush diameter	Sidebars		Pin		Ultimate tensile strength	Rated working load	Weight Per meter
		b1(min)	D(max)	h	T	d	L	Q(min)	kN	q
	mm	mm	mm	mm	mm	mm	mm	kN		kg/m
ZY850	152.4	57.15	50.8	82.6	16	33.27	157	634.7	45.3	36.6
ZY6066	152.4	75.8	76.2	120.7	19.05	44.45	184	1778	124.5	81.3
ZY886	177.8	68.33	66.68	101.6	19.05	41.07	172.2	1300	84.5	60.2