

工程输送链 Engineering Conveyor Chains

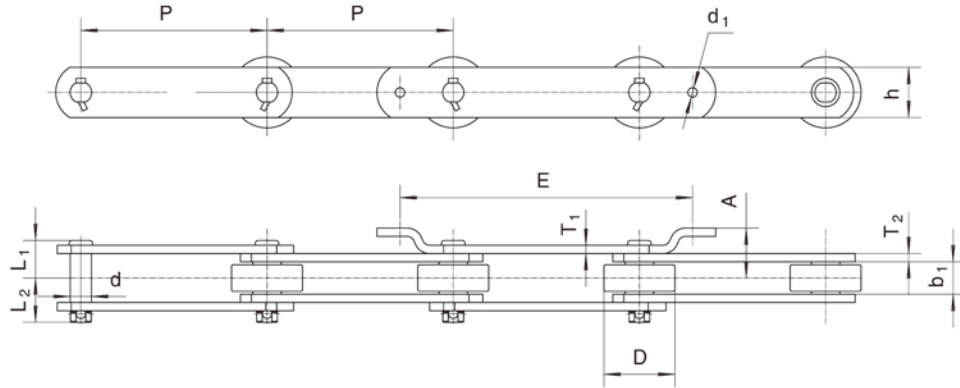

链号	节距	内节内宽	滚子外径	销轴		链板		最小抗拉强度	附件		
Chain No.	Pitch	Width between inner Sidebars	Roller Diameter	Pin		Sidebar		Ultimate Tensile Strength	ATT.		
	P	b ₁ (min)	D(max)	d	L	h	T ₁ /T ₂	Fu(min)	F	E	d ₁
	mm	mm	mm	mm	mm	mm	mm	kN	mm	mm	mm
4004-G5	228.6	66.8	76.2	25.4	144.5	63.5	12.7	288	84.8	355.6	15.88
4009-G5	228.6	57.15	76.2	22.35	116.8	63.5	9.6	297	77	355.6	15.88
4010-G5	304.8	82.55	114.3	38.1	172.5	101.6	16	822	99.1	476.25	15.88
4065-G5	228.6	77.7	107.95	31.75	165.6	88.9	16	657	100	355.6	20.64

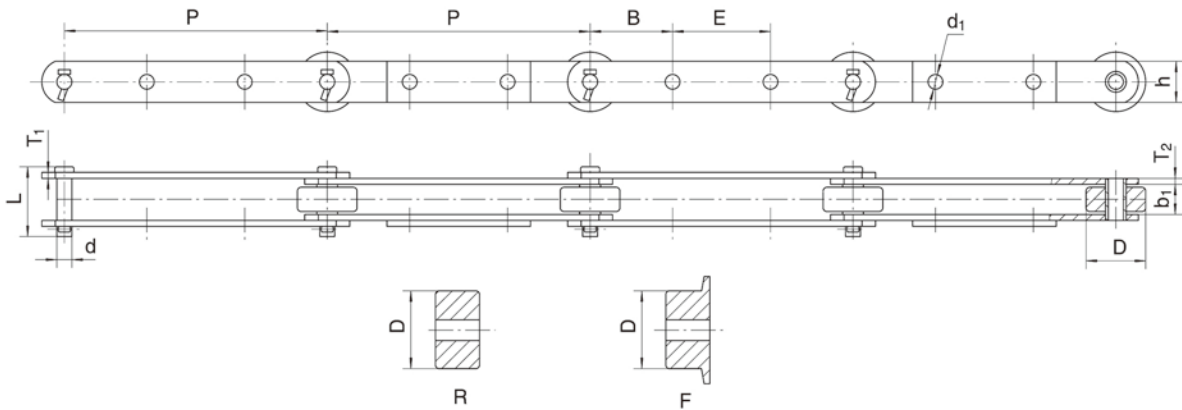

链号	节距	内节内宽	滚子外径	销轴		链板		最小抗拉强度	附件		
Chain No.	Pitch	Width between inner Sidebars	Roller Diameter	Pin		Sidebar		Ultimate Tensile Strength	ATT		
	P	b ₁ (min)	D(max)	d	L	h	T ₁ /T ₂	Fu(min)	B	E	d ₁
	mm	mm	mm	mm	mm	mm	mm	kN	mm	mm	mm
RS911	228.6	50.8	76.2	16	87.63	50.8	7.9	146	79.5	69.85	11.11
SS922	228.6	50.8	88.9	19.05	108.7	50.8	9.6	151	76.2	76.2	12.7
SS927	228.6	50.8	88.9	19.05	108.7	50.8	9.6	151	76.2	76.2	12.7
SS933	228.6	57.15	101.6	22.35	117.1	63.5	9.6	213	82.55	63.5	12.7
SS1222	304.8	50.8	114.3	19.05	109.5	50.8	9.6	151	104.9	95.25	12.7
SS1227	304.8	50.8	88.9	19.05	109.5	50.8	9.6	151	104.9	95.25	12.7
SS1232	304.8	50.8	114.3	19.05	106.7	50.8	9.6	204	104.9	95.25	12.7
SS1233	304.8	57.15	101.6	22.35	117.85	63.5	9.6	275	104.9	95.25	12.7
SS4038	304.8	41.4	82.55	19.05	97	50.8	9.6	128	104.9	95.25	12.7
RS4850	304.8	55.6	76.2	22.35	116.1	63.5	9.6	280	104.9	95.25	19.05