

## 输送用平顶链链轮 Sprocket wheel for conveyor Flat-Top chains

适用于钢制单铰直输平顶链、钢制无导侧弯平顶链  
Used for Steel single hinge Straight Run Flat-TOP Chains and Steel Sideflex Chain without tab

### HKU815

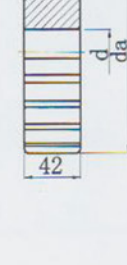

型号 No.	齿数 Actual Teeth	齿顶圆直径 Pitch Dia Max da	分度圆直径 Outer Dia	轴径 Bore d
HKU815-T19R	19	117	117.34	25,30,35,40,45
HKU815-T21R	21	129	129.2	25,30,35,40,45
HKU815-T23R	23	142	141.2	25,30,35,40,45
HKU815-T25R	25	154	153.2	25,30,35,40,45

### HKS815

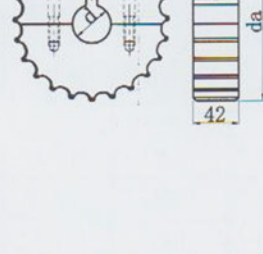

型号 No.	齿数 Actual Teeth	齿顶圆直径 Pitch Dia Max da	分度圆直径 Outer Dia	轴径 Bore d
HKS815-T19R	19	117	117.34	25,30,35,40,45
HKS815-T21R	21	129	129.2	25,30,35,40,45
HKS815-T23R	23	142	141.2	25,30,35,40,45
HKS815-T25R	25	154	153.2	25,30,35,40,45

### HNS815

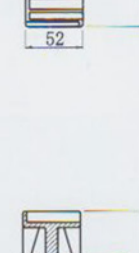
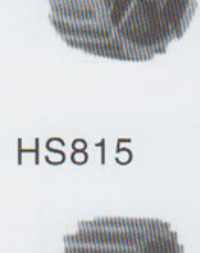

型号 No.	齿数 Actual Teeth	齿顶圆直径 Pitch Dia Max da	分度圆直径 Outer Dia	轴径 Bore d
HNS815-T21R	21	129	129.2	25,30,35,40,45
HNS815-T23R	23	142	141.2	25,30,35,40,45
HNS815-T25R	25	154	153.2	25,30,35,40,45

### HS815



型号 No.	齿数 Actual Teeth	齿顶圆直径 Pitch Dia Max da	分度圆直径 Outer Dia	轴径 Bore d
HS815-T21R	21	129	129.2	25,30,35,40,45

## 输送用平顶链链轮 Sprocket wheel for conveyor Flat-Top chains

适用于塑料单铰直输平顶链  
Used for Engineering Plastic Straight Run Flat-TOP Chain

### HKU820

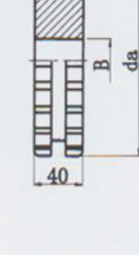

型号 No.	齿数 Actual Teeth	齿顶圆直径 Pitch Dia Max da	分度圆直径 Outer Dia	轴径 Bore d
HKU820-T19R	19	117	117.34	25,30,35,40,45
HKU820-T21R	21	129	129.2	25,30,35,40,45
HKU820-T23R	23	142	141.2	25,30,35,40,45
HKU820-T25R	25	154	153.2	25,30,35,40,45

### HKS820

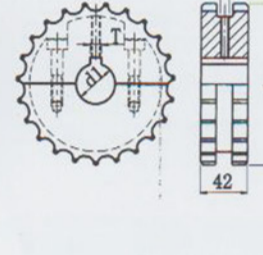
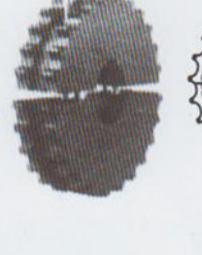

型号 No.	齿数 Actual Teeth	齿顶圆直径 Pitch Dia Max da	分度圆直径 Outer Dia	轴径 Bore d
HKS820-T19R	19	117	117.34	25,30,35,40,45
HKS820-T21R	21	129	129.2	25,30,35,40,45
HKS820-T23R	23	142	141.2	25,30,35,40,45
HKS820-T25R	25	154	153.2	25,30,35,40,45

### HNS820

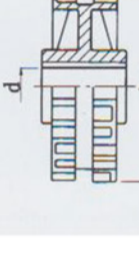

型号 No.	齿数 Actual Teeth	齿顶圆直径 Pitch Dia Max da	分度圆直径 Outer Dia	轴径 Bore d
HNS820-T21R	21	129	129.2	25,30,35,40,45
HNS820-T23R	23	142	141.2	25,30,35,40,45
HNS820-T25R	25	154	153.2	25,30,35,40,45

## 输送用平顶链链轮 Sprocket wheel for conveyor Flat-Top chains

适用于塑料双铰直输平顶链、钢制双铰直输平顶链  
Used for Engineering Plastic double hinge Straight Run Flat-TOP Chain and Steel double hinge Straight run Flat-Top Chain

### HKU821

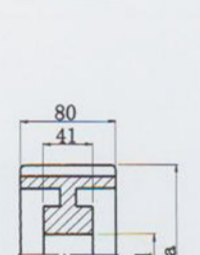

型号 No.	齿数 Actual Teeth	齿顶圆直径 Pitch Dia Max da	分度圆直径 Outer Dia	轴径 Bore d
HKU821-T21R	21	129	129.2	25,30,35,40,45
HKU821-T23R	23	142	141.2	25,30,35,40,45
HKU821-T25R	25	154	153.2	25,30,35,40,45

### HGG821



型号 No.	齿数 Actual Teeth	齿顶圆直径 Pitch Dia Max da	分度圆直径 Outer Dia	轴径 Bore d
HGG821-T25R	25	154	153.2	25,30,35,40,45

### HKS821

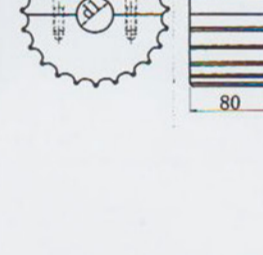

型号 No.	齿数 Actual Teeth	齿顶圆直径 Pitch Dia Max da	分度圆直径 Outer Dia	轴径 Bore d
HKS821-T21R	21	129	129.2	25,30,35,40,45
HKS821-T23R	23	142	141.2	25,30,35,40,45
HKS821-T25R	25	154	153.2	25,30,35,40,45

### HNS821

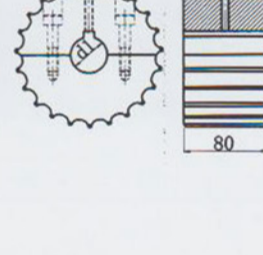

型号 No.	齿数 Actual Teeth	齿顶圆直径 Pitch Dia Max da	分度圆直径 Outer Dia	轴径 Bore d
HNS821-T21R	21	129	129.2	25,30,35,40,45
HNS821-T23R	23	142	141.2	25,30,35,40,45
HNS821-T25R	25	154	153.2	25,30,35,40,45

## 输送用平顶链链轮 Sprocket wheel for conveyor Flat-Top chains

适用于塑料带翼侧弯平顶链  
Used for Engineering Plastic Sideflex Flat-TOP with Tab

### HKU880

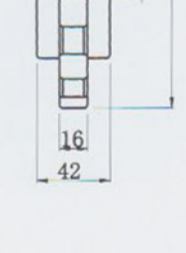

型号 No.	齿数 Actual Teeth	齿顶圆直径 Pitch Dia Max da	分度圆直径 Outer Dia	轴径 Bore d
HKU880-T10R	10	122	132.29	25,30,35,40,45
HKU880-T11R	11	135	135.23	25,30,35,40,45
HKU880-T12R	12	147	147.21	25,30,35,40,45

### HKS880

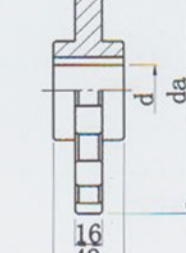

型号 No.	齿数 Actual Teeth	齿顶圆直径 Pitch Dia Max da	分度圆直径 Outer Dia	轴径 Bore d
HKS880-T10R	10	122	132.29	25,30,35,40,45
HKS880-T11R	11	135	135.23	25,30,35,40,45

### HN880

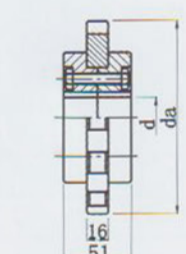

型号 No.	齿数 Actual Teeth	齿顶圆直径 Pitch Dia Max da	分度圆直径 Outer Dia	轴径 Bore d
HN880-T12R	12	147	147.21	25,30,35,40,45

### HNS880

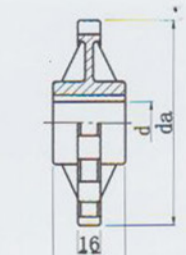

型号 No.	齿数 Actual Teeth	齿顶圆直径 Pitch Dia Max da	分度圆直径 Outer Dia	轴径 Bore d
HNS880-T10R	10	122	132.29	25,30,35,40,45
HNS880-T12R	12	147	147.21	25,30,35,40,45

## 输送用平顶链链轮 Sprocket wheel for conveyor Flat-Top chains

适用于钢制导向侧弯链  
Used for Steel Sideflex Chain with Tab

### HKU881

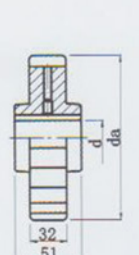

型号 No.	齿数 Actual Teeth	齿顶圆直径 Pitch Dia Max da	分度圆直径 Outer Dia	轴径 Bore d
HKU881-T21R	21	129	129.2	25,30,35,40,45
HKU881-T23R	23	142	141.2	25,30,35,40,45
HKU881-T25R	25	154	153.2	25,30,35,40,45

### HNS881

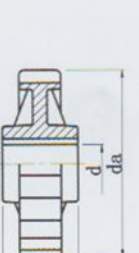
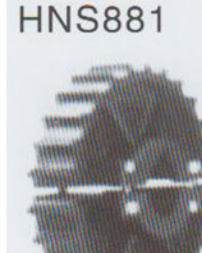

型号 No.	齿数 Actual Teeth	齿顶圆直径 Pitch Dia Max da	分度圆直径 Outer Dia	轴径 Bore d
HNS881-T21R	21	129	129.2	25,30,35,40,45
HNS881-T23R	23	142	141.2	25,30,35,40,45
HNS881-T25R	25	154	153.2	25,30,35,40,45

### HXT820单铰直输被动轮 Passive wheel for Single hinge Straight run

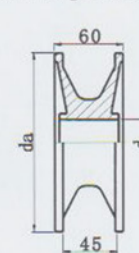

型号 No.	齿数 Actual Teeth	顶圆直径 Pitch Dia Max da	轴径 Bore d
HXT820-T19R	19	118	25,30,35,40
HXT820-T21R	21	129	25,30,35,40,45
HXT820-T23R	23	142	25,30,35,40,45
HXT820-T25R	25	154	25,30,35,40,45

### HXS821双铰直输被动轮 Passive wheel for double hinge straight run

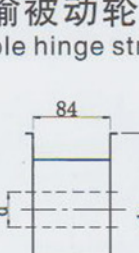
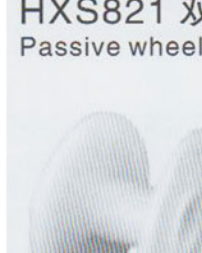

型号 No.	齿数 Actual Teeth	顶圆直径 Pitch Dia Max da	轴径 Bore d
HXS821-T21R	21	129	25,30,35,40,45
HXS821-T23R	23	142	25,30,35,40,45
HXS821-T25R	25	154	25,30,35,40,45