

窄系列焊接弯板链 Narrow Series Welded Crank-Link Mill Chains

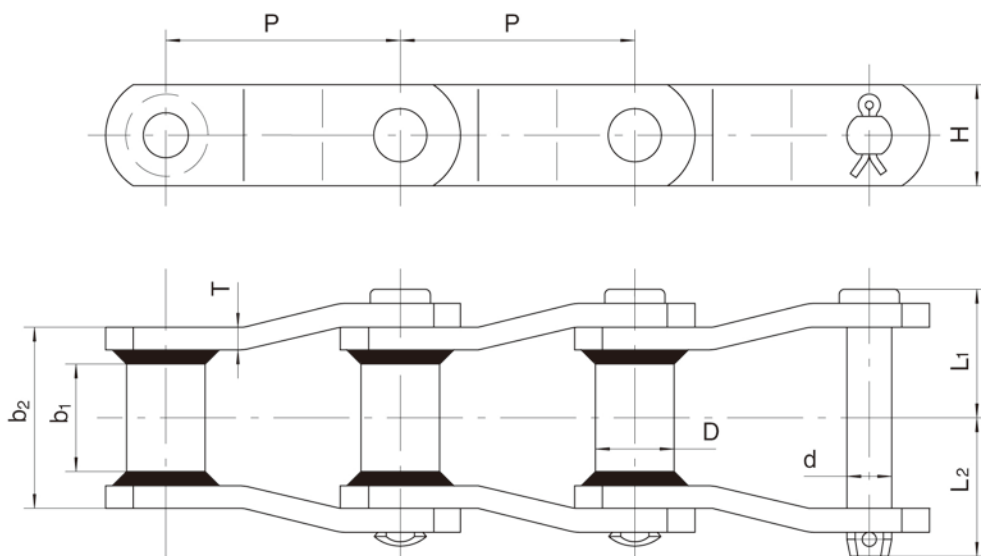

| 链号 Chain No. | 节距 Pitch | 窄端 Narrow end | | 套筒外径 Bush diameter | 链板 Sidebars | | 销轴 Pin | | | 最小抗拉强度 Ultimate tensile strength | 许用工作载荷 Rated working load | 每米重量 Weight per meter |
|-----------------|-------------|----------------------------|----------------------------|-----------------------|----------------|---------|-----------|----------------------|----------------------|-------------------------------------|------------------------------|--------------------------|
| | P mm | b ₁ (min) mm | b ₂ (max) mm | D(max) mm | h mm | T mm | d mm | L ₁ mm | L ₂ mm | Fu (min) kN | kN | q kg/m |
| WR78 | 66.27 | 28.4 | 51 | 22.23 | 28.6 | 6.4 | 12.7 | 36.3 | 39.5 | 106.8 | 10.5 | 5.94 |
| DWR78 | 66.27 | 28.4 | 51 | 21.4 | 31.8 | 6.4 | 12.7 | 36.3 | 39.5 | 125 | 12.1 | 6.42 |
| WR78B | 66.27 | 28.4 | 51 | 27 | 31.8 | 6.4 | 12.7 | 36.3 | 39.5 | 125 | 12.1 | 7.03 |
| WSR78 | 66.27 | 20 | 41.3 | 21.3 | 25.4 | 6.4 | 12.7 | 31.5 | 34.6 | 85.3 | 8.3 | 5.21 |
| WR78HD | 66.95 | 25.4 | 51.2 | 25.4 | 31.8 | 9.5 | 14.27 | 40.2 | 45.3 | 133.4 | 14.7 | 9.41 |
| WR82 | 78.1 | 31.8 | 57.4 | 25.4 | 31.8 | 6.4 | 14.27 | 40 | 43.5 | 133.4 | 14.7 | 6.83 |
| *WR82SS | 78.1 | 31.8 | 57.4 | 25.4 | 31.8 | 6.4 | 14.27 | 40 | 43.5 | 133.4 | 14.7 | 6.83 |
| WR82HD | 78.1 | 28.6 | 60.8 | 31.75 | 38.1 | 9.5 | 19.05 | 46.5 | 50.8 | 215 | 20.5 | 12.71 |
| WR124 | 101.6 | 38.1 | 71.5 | 31.8 | 38.1 | 9.5 | 19.05 | 52 | 56 | 204 | 20.5 | 11.52 |
| WR124HD | 103.2 | 38.1 | 76.3 | 41.28 | 50.8 | 12.7 | 25.4 | 59.4 | 64.3 | 378 | 46.5 | 21.33 |
| WR111 | 120.9 | 50.8 | 85.6 | 31.8 | 44.5 | 9.5 | 19.05 | 59.4 | 63.3 | 270 | 32.5 | 13.05 |
| WR106 | 152.4 | 38.1 | 71.5 | 31.8 | 38.1 | 9.5 | 19.05 | 52 | 56 | 204 | 20.5 | 9.65 |
| WR110 | 152.4 | 44.5 | 76.5 | 31.8 | 38.1 | 9.5 | 19.05 | 54.4 | 59.6 | 204 | 20.5 | 9.57 |
| WR132 | 153.67 | 69.85 | 111.6 | 44.5 | 50.8 | 12.7 | 25.4 | 77.3 | 81.7 | 345 | 42.5 | 21.08 |
| WR150 | 153.67 | 69.85 | 111.6 | 44.5 | 63.5 | 12.7 | 25.4 | 77.3 | 81.7 | 345 | 42.5 | 24.93 |

带“*”材质为不锈钢

With “*” means stainless steel material.

链条销轴经过热处理硬化，链板和套筒不热处理

All pins of chain have been hardened through heat treatment. Sidebar and bush have not been heat treated!

窄系列焊接弯板链 Narrow Series Welded Crank-Link Mill Chains

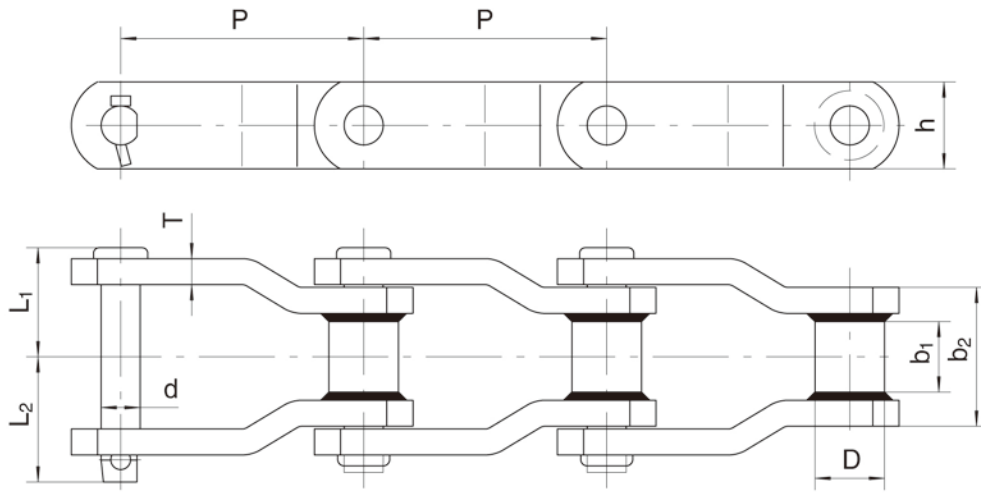

| 链号 Chain No. | 节距 Pitch | 窄端 Narrow end | | 套筒外径 Bush diameter | 链板 Sidebars | | 销轴 Pin | | | 最小抗拉强度 Ultimate tensile strength | 许用工作载荷 Rated working load | 每米重量 Weight per meter |
|-----------------|-------------|----------------------------|----------------------------|-----------------------|----------------|---------|-----------|----------------------|----------------------|-------------------------------------|------------------------------|--------------------------|
| | P mm | b ₁ (min) mm | b ₂ (max) mm | D(max) mm | h mm | T mm | d mm | L ₁ mm | L ₂ mm | Fu (min) kN | kN | q kg/m |
| WH78 | 66.27 | 28.4 | 51 | 22.23 | 28.6 | 6.4 | 12.7 | 36.3 | 39.5 | 160 | 15.6 | 5.92 |
| WH78B | 66.27 | 28.4 | 51 | 27 | 31.8 | 6.4 | 12.7 | 36.3 | 39.5 | 160 | 15.6 | 6.98 |
| WH78HD | 66.95 | 25.4 | 51.2 | 25.4 | 31.8 | 9.5 | 14.27 | 40.2 | 45.3 | 200 | 19.6 | 9.4 |
| WH82 | 78.1 | 31.8 | 57.4 | 27 | 31.8 | 6.4 | 14.27 | 40 | 43.5 | 200 | 19.6 | 7.14 |
| WH82HD | 78.1 | 28.6 | 60.8 | 31.75 | 38.1 | 9.5 | 19.05 | 46.5 | 50.8 | 320 | 32.7 | 12.7 |
| WH9103HD | 78.1 | 28.6 | 57.9 | 31.75 | 38.1 | 9.5 | 18.95 | 43.5 | 48.4 | 320 | 32.9 | 11.9 |
| WH124 | 101.6 | 38.1 | 71.5 | 31.8 | 38.1 | 9.5 | 19.05 | 52 | 56 | 320 | 32.7 | 11.5 |
| WH124HD | 103.2 | 38.1 | 76.3 | 41.28 | 50.8 | 12.7 | 25.4 | 59.4 | 64.3 | 540 | 66.8 | 21.3 |
| WH111 | 120.9 | 50.8 | 85.6 | 31.8 | 44.5 | 9.5 | 19.05 | 59.4 | 63.3 | 320 | 39.5 | 13 |
| WH720 | 152.4 | 28.5 | 55 | 32 | 40 | 10 | 19.05 | 44.5 | 49.5 | 350 | 35.8 | 9.7 |
| WH106 | 152.4 | 38.1 | 71.5 | 31.8 | 38.1 | 9.5 | 19.05 | 52 | 56 | 320 | 32.7 | 9.6 |
| WH110 | 152.4 | 44.5 | 76.5 | 31.8 | 38.1 | 9.5 | 19.05 | 54.4 | 59.6 | 320 | 32.7 | 9.6 |
| WH132HD | 153.67 | 69.85 | 119.03 | 44.5 | 50.8 | 15.9 | 25.4 | 84 | 89.7 | 540 | 69.3 | 24.8 |

所有零件经过热处理硬化

All components of chain have been hardened through heat treatment.

窄系列焊接弯板链 Narrow Series Welded Crank-Link Mill Chains

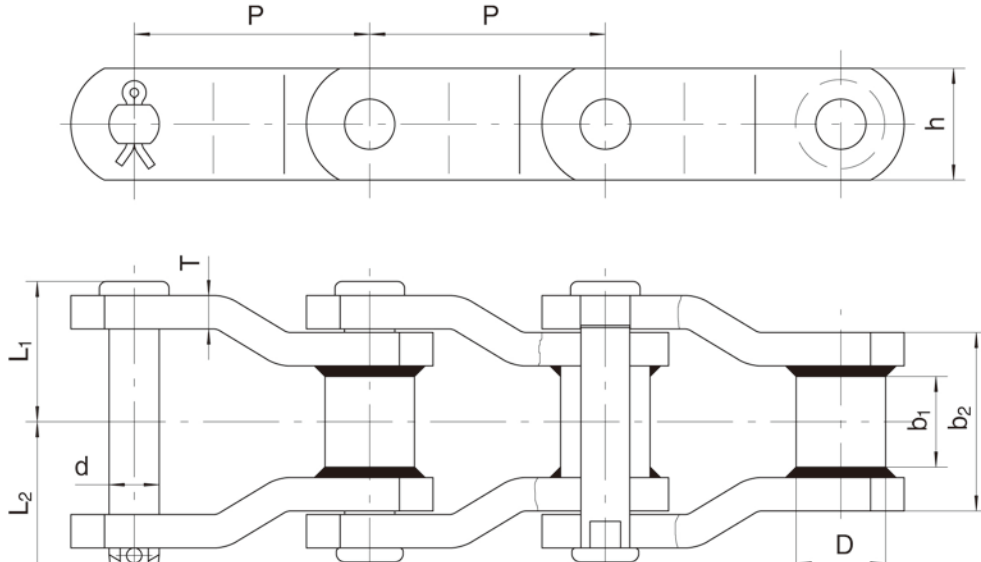

| 链号 Chain No. | 节距 Pitch | 窄端 Narrow end | | 套筒外径 Bush diameter | 链板 Sidebars | | 销轴 Pin | | | 最小抗拉强度 Ultimate tensile strength | 许用工作载荷 Rated working load | 每米重量 weight per meter |
|-----------------|-------------|------------------|----------------|-----------------------|----------------|---------|-----------|----------------------|----------------------|-------------------------------------|------------------------------|--------------------------|
| | | b ₁ | b ₂ | | h mm | T mm | d mm | L ₁ mm | L ₂ mm | | | |
| | | (min) mm | (max) mm | | | | | | | | | |
| WHX124 | 101.6 | 38.1 | 71.5 | 36.55 | 38.1 | 9.5 | 19.05 | 51.8 | 56.2 | 320 | 32.7 | 12.5 |
| WHX124HD | 103.2 | 38.1 | 76.3 | 41.28 | 50.8 | 12.7 | 25.4 | 59.4 | 64.3 | 540 | 66.8 | 20.7 |
| WHX111 | 120.9 | 50.8 | 85.6 | 36.55 | 38.1 | 9.5 | 19.05 | 58.7 | 64.5 | 320 | 39.5 | 12.5 |
| WHX111HD | 120.9 | 57.15 | 91.96 | 36.53 | 50.8 | 12.7 | 19.05 | 65.5 | 69.5 | 320 | 39.5 | 19.1 |
| WHX132 | 153.67 | 69.85 | 111.6 | 44.5 | 50.8 | 12.7 | 25.4 | 77.3 | 81.7 | 540 | 66.8 | 20.4 |
| WHX132HD | 153.67 | 69.85 | 119.03 | 44.5 | 50.8 | 15.9 | 25.4 | 84 | 89.7 | 540 | 69.3 | 24.8 |
| WHX106 | 152.4 | 38.1 | 71.5 | 36.55 | 38.1 | 9.5 | 19.05 | 51.8 | 56.2 | 320 | 32.7 | 9.7 |
| WHX150 | 153.67 | 69.85 | 111.6 | 44.5 | 63.5 | 12.7 | 25.4 | 77.3 | 81.7 | 540 | 66.8 | 24.5 |
| FWHX150 | 153.67 | 69.85 | 110 | 44.5 | 65 | 12 | 25 | 75 | 81 | 520 | 64.5 | 24.7 |
| WHX155 | 153.67 | 69.85 | 112.1 | 44.5 | 63.5 | 14.3 | 28.4 | 77.4 | 87.5 | 660 | 77.8 | 27.7 |
| WHX157 | 153.67 | 69.85 | 118.1 | 44.5 | 63.5 | 15.9 | 28.55 | 81.4 | 92.6 | 750 | 80.9 | 29.3 |
| WHX159 | 155.58 | 73 | 118.1 | 50.8 | 76.2 | 15.9 | 31.5 | 83 | 84.8 | 930 | 90 | 38.4 |
| WHX4855 | 304.8 | 69.85 | 116.9 | 44.5 | 63.5 | 15.9 | 31.55 | 81.8 | 84.3 | 780 | 76.8 | 22.5 |
| WHX4859 | 304.8 | 73 | 118.1 | 50.8 | 76.2 | 15.9 | 31.5 | 83 | 84.8 | 930 | 87.5 | 28.9 |

所有零件经过热处理硬化，销轴表面感应硬化处理

All components of chain have been hardened through heat treatment and pin has been surface induction hardened.